

METAL MC RANGE

MC-M5/F5/F10 INSTALLATION GUIDE

MC-M5/F5/F10 INSTALLATION GUIDE (SELF TAPPING)

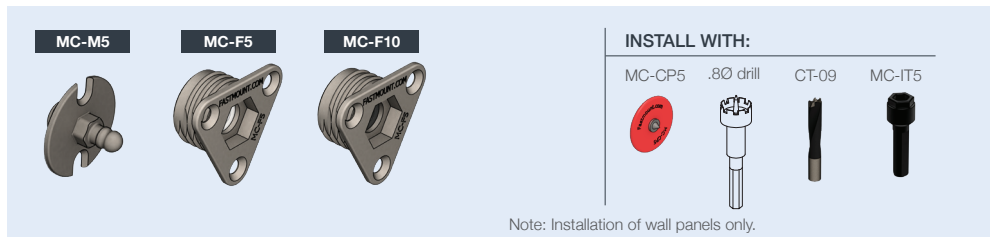

INSTALLATION STEPS Self tapping method

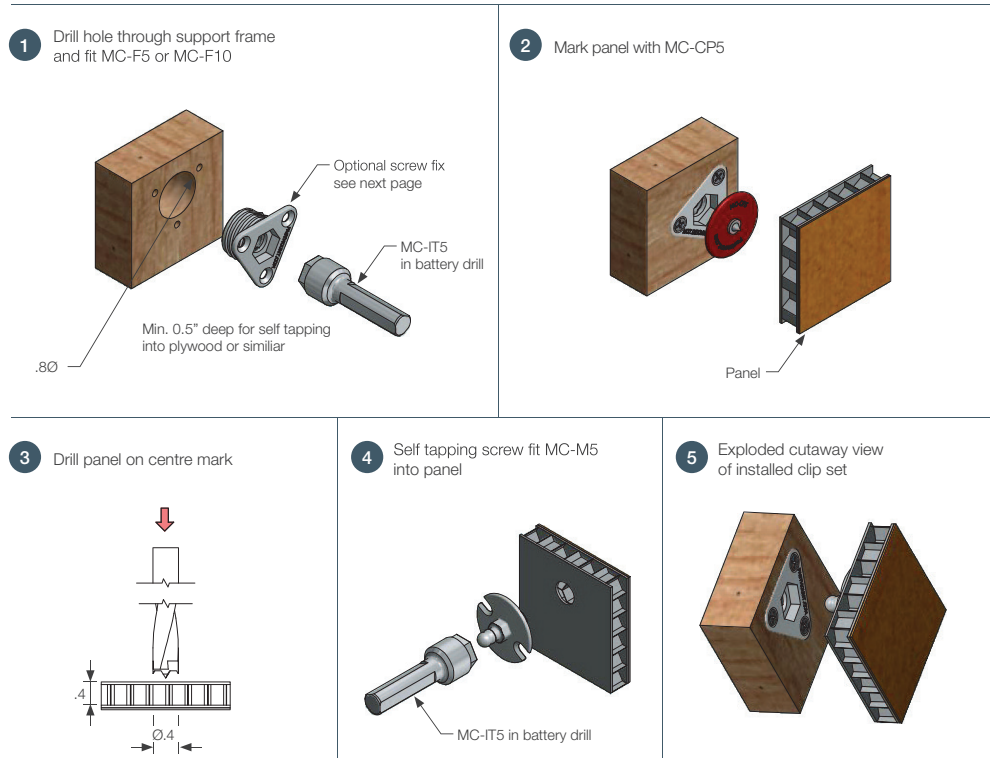

MORE INFO: SETOUT GUIDE TD-02, 09, 12. PRODUCT SHEET MC-05

METAL MC RANGE

MC-M5/F5/F10 INSTALLATION GUIDE

MC-M5/F5/F10 INSTALLATION GUIDE (SCREW FIX)

| MC-M5 | MC-F5 | MC-F10 | USE WITH: | INSTALL WITH: |
|-------|-------|--------|-----------------------|--|
| | | | #4 gauge CSK screw | MC-CP5 #40 drill CT-09 MC-IT5 |

Note: Installation of wall panels only.

INSTALLATION STEPS Screw fix method

- 1** Drill hole through support frame and fit MC-F5 or MC-F10

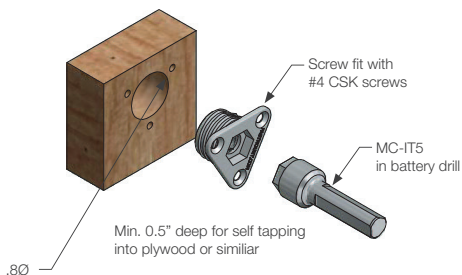

- 2** Mark panel with MC-CP5

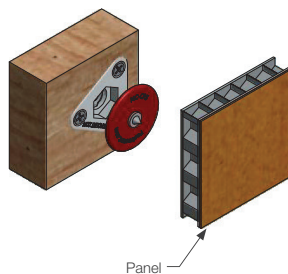

- 3** MC-M5 screw fixed to panel

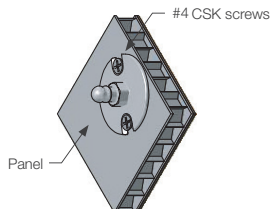

- 4** Exploded cutaway view of installed clip set

