

How to guides

Using hidden fixings to create negative detail with wall panels.

Tools



CT-13A



CT-03



CT-09



CT-09DG



CT-10



CP-01ST

Clips



PC-M1B



PC-F1A

Panel and substrate



Spectrum Eco by
Plytech 12mm panel

Pine construction
plywood 12mm

5mm x 20mm
foam tape

In collaboration with

plytech
CREATIVE STRENGTH

FASTMOUNT
PANEL MOUNTING SOLUTIONS

Installation steps

Installing PC-F1A into substrate

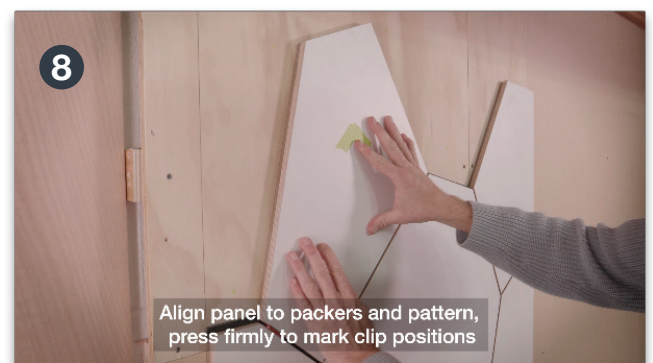
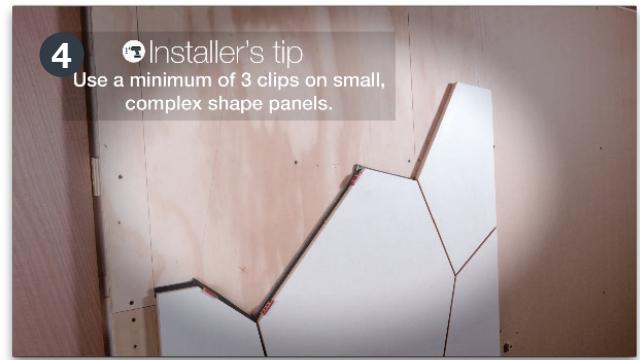
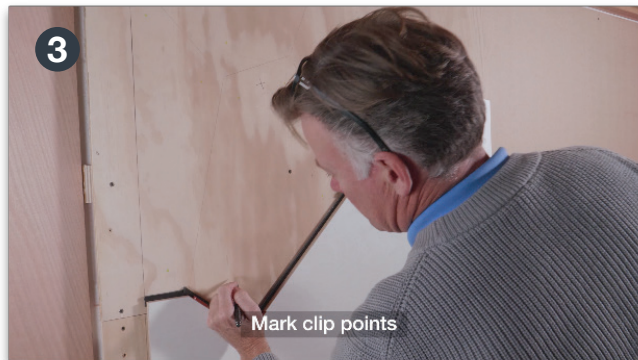
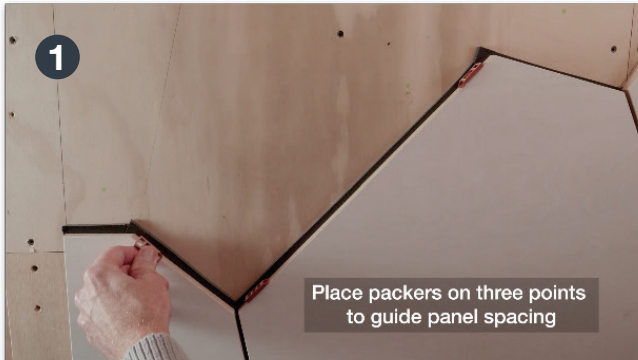

Installation steps

Installing PC- MIB into panel and mounting

